



## IMPORTANT! WARRANTY AND INSTALLATION INSTRUCTIONS

*Please Forward All Information to Consumer*

Be sure to review the enclosed instructions prior to beginning the installation process. If you have any questions about the enclosed parts or instructions, or if you encounter a problem during installation:

**CALL TECHNICAL SUPPORT: 440.891.0999 or 800.486.0999**

**TO ACTIVATE YOUR WARRANTY GO TO:  
[CORSAPERFORMANCE.COM/WARRANTY](https://corsaperformance.com/warranty)**

**COLOR INSTRUCTIONS ARE AVAILABLE BY PART NUMBER ON: [CORSAPERFORMANCE.COM](https://corsaperformance.com)**



**NEVER work on a hot exhaust system.**  
Allow time for the vehicle to cool.

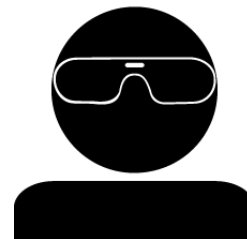

**Always wear eye protection**  
when working under a vehicle.

**INSTALL DIFFICULTY** 

### RECOMMENDED TOOLS & SUPPLIES

- 3/8" Drive 15mm Socket
- 3/8" Drive Ratchet
- 3/8" Drive 16mm Socket
- 3/8" Drive Torque Wrench

**Please take time to read and understand these installation instructions.**

CORSA recommends that the installation of this system be performed by a qualified service center or professional installer who has the necessary equipment, tools, and experienced personnel. However, if you decide to perform this installation yourself, the use of an additional person may be required.

**WARNING:** Never work on a hot exhaust system. Allow time for the vehicle to cool. Always wear eye protection when working under a vehicle.

CORSA Performance makes no representation or warranty, expressed or implied that its downpipe or header products and or components there-in comply with federal, state or local emission levels, noise levels, or safety standards or that any of their parts conform with the racing vehicles exemption, unless otherwise noted. The purchaser assumes all responsibility for such use and compliance.

This warranty does not extend to damaged or defect in the finish of a product or to any product, that in the opinion of CORSA Performance, has been misused, damaged by accident or negligence, altered or modified in any way, faulty installation or installed contrary to CORSA installation instructions, or repaired by an unauthorized service facility.

Full warranty available on [www.corsaperformance.com](http://www.corsaperformance.com)

**Please confirm that all parts are present according to the bill of materials before beginning the installation.**

If something is missing call Tech Support at 440.891.099 or Toll Free: 1.800.486.0999

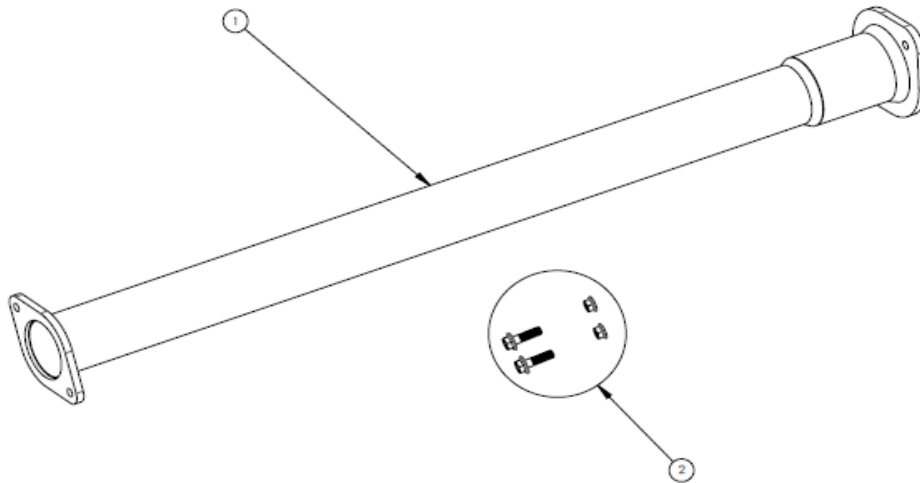

**BILL OF MATERIALS**

1.	18DR4165 (Res Delete ASM)	2.	18DR7072 (Hardware Kit)
----	---------------------------	----	-------------------------

**CAUTION:** Never work on a hot exhaust system. Allow the vehicle to cool for at least an hour and a half. Always wear eye protection when working under a vehicle. It is recommended to use cotton gloves in order to protect stainless steel surfaces from permanent grease and oil stains.

### REMOVAL INSTRUCTIONS

### FACTORY EXHAUST



**1.** Remove the nuts from the front flange using a 15mm socket or wrench.



**2.** Remove the bolts from the rear flange using a 16mm socket or wrench.

**3.** Carefully remove the stock Mid-Pipe from vehicle.

**Step 3** concludes the removal of the factory exhaust.

### WARNING! DO NOT SKIP THIS STEP!

Apply the anti-seize lubricant (*supplied*) to the threads **ONLY** of all the clamps and flange bolts. Failure to follow this procedure can cause nuts to seize on clamps and potentially destroy threads.

After applying anti-seize lubricant, be sure to **thoroughly** clean your hands, as lubricant will tarnish stainless steel.

All clamps should be tightened using a properly calibrated Torque Wrench. Using an air impact gun will damage the clamp and reduce its ability to effectively seal the joint. It may also cause the joint to separate, thereby causing damage to your exhaust system and to your vehicle.

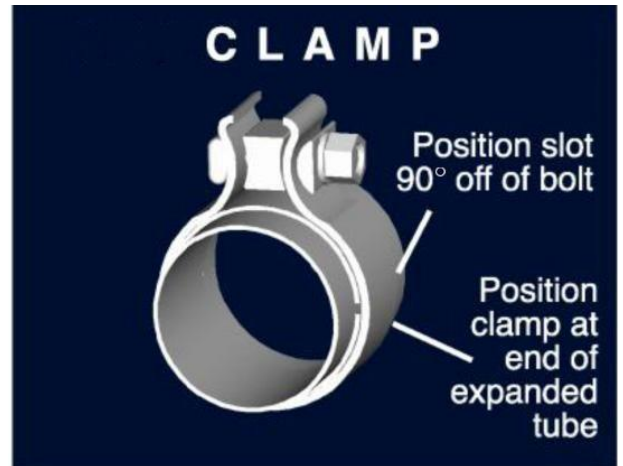

**NOTE:** Align all clamps so that the center of the clamp bolt is 90 degrees from the notch in the pipe.

### INSTALLATION INSTRUCTIONS

CORSA EXHAUST



**1.** Install Corsa Res Delete assembly as shown.



**2.** Position the floating flange and secure the stock 15mm nuts on the bolts using a 15mm socket and ratchet. Only Snugly tighten at this time.

### INSTALLATION INSTRUCTIONS

CORSA EXHAUST



3. Align the rear flange with the mating flange on the muffler. Position the stock 16mm bolt on the rear flange and snug it using a 16mm socket or wrench.

**NOTE:** Use the supplied hardware and a 17mm & 15mm socket or wrench when mating it to a Corsa Exhaust System.

5. Visually inspect the system position and clearance. Make necessary adjustments at the flanges.



4. Center the flare, and the floating flange and tighten the nuts on the floating flange to 40FT/LBS and then tighten the nuts on the rear flange to 35 FT/LBS.

Step 5 concludes the installation of your Corsa Resonator Delete Kit.

**NOTE:** During cold weather start-ups, you may experience an exhaust sound that is deeper and louder in tone than usual. This is temporary and will diminish to normal levels once your engine has reached its normal operating temperature.

**NOTE:** Immediately following the installation of your exhaust system, you may experience a trace of smoke after initial start-up. DO NOT be alarmed. The smoke is caused by the burning of a small amount of forming oil residue used in the manufacturing process.

**NOTE:** It is strongly suggested that all clamps be checked and tightened after road testing the vehicle once the system has cooled.