

S5152

19-UP RAM 1500, 5.7L HEMI, CAT BACK,
REAR EXIT DUALS. CREW CAB AND QUAD
CAB MODELS

MBRP
INC.
PERFORMANCE EXHAUST

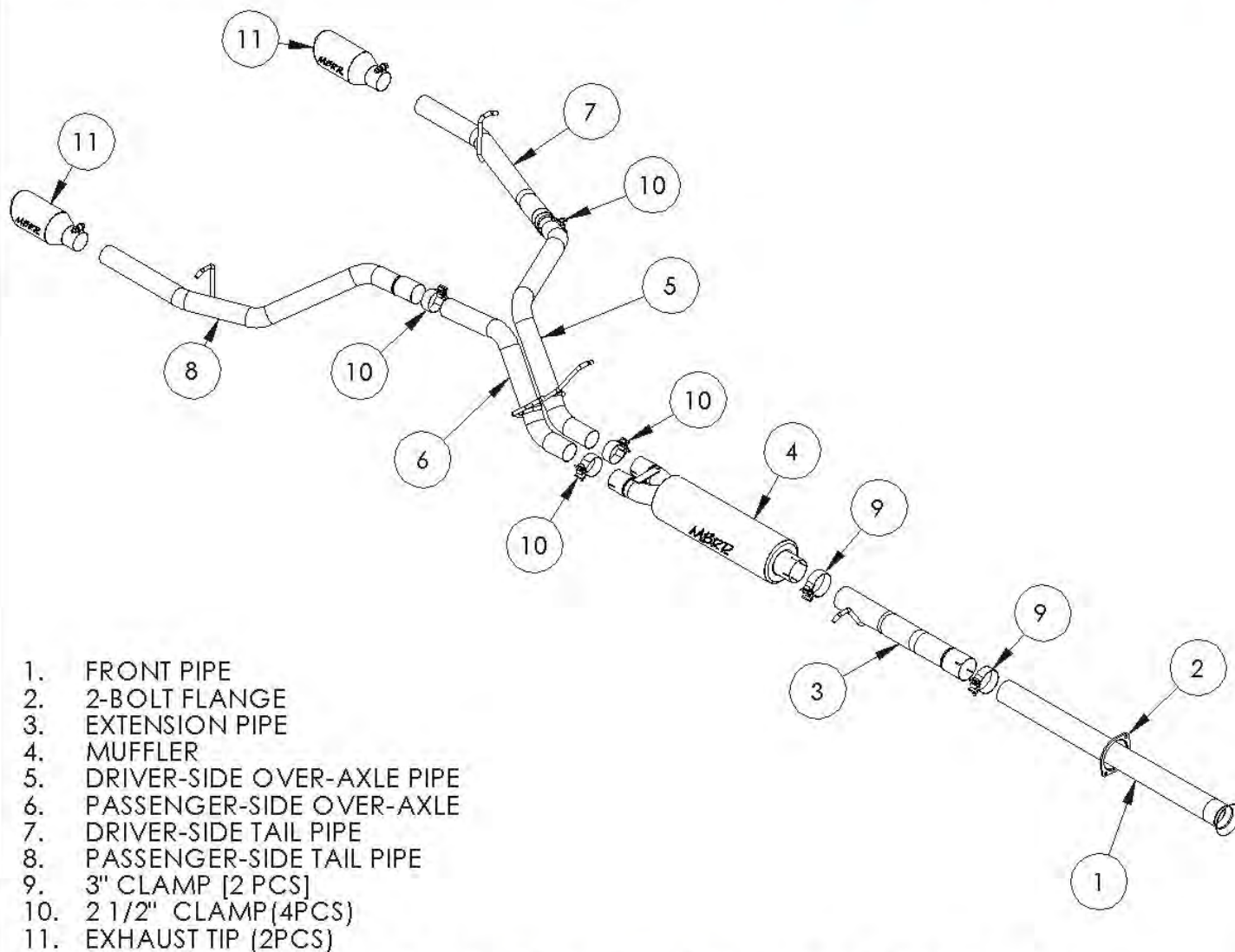

1. FRONT PIPE
2. 2-BOLT FLANGE
3. EXTENSION PIPE
4. MUFFLER
5. DRIVER-SIDE OVER-AXLE PIPE
6. PASSENGER-SIDE OVER-AXLE
7. DRIVER-SIDE TAIL PIPE
8. PASSENGER-SIDE TAIL PIPE
9. 3" CLAMP [2 PCS]
10. 2 1/2" CLAMP (4PCS)
11. EXHAUST TIP (2PCS)

PLEASE READ BEFORE STARTING INSTALLATION

While MBRP Inc. has made every effort to ensure that all components of this system are of superior quality and properly packaged, it is the installer's responsibility to ensure the following before removal of the factory exhaust:

- that ALL components shown above are present.
- that ALL mating components fit together.
- that there are no damaged components.
- that the system you have purchased is appropriate for your vehicle year, model and configuration.
- that the system will not interfere with any modifications previously installed or planned.
- that you have read and understand these instructions.

If you have any questions or are uncertain about any aspect of the installation of this system to your vehicle please contact your dealer before commencing installation.

Removal of Stock System:



Figure 1

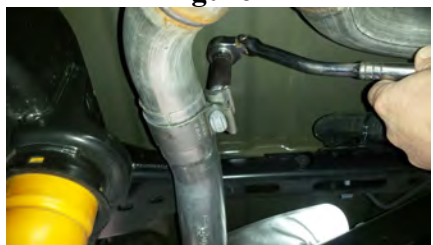

Figure 2



Figure 3



Figure 4



Figure 5

1. Apply a penetrating lubricant liberally to all hangers, hardware and rubber isolators.
2. Remove both OEM tips from the truck.
3. Unbolt and remove the OEM front pipe assembly. Set the 2 nuts aside as they will be reused.
Refer to Figure 1.
4. Loosen the passenger-side tailpipe clamp before removing the hanger from the rubber isolator. Remove the passenger-side tailpipe assembly.
Refer to Figure 2.
5. Remove the driver-side upper sway bar link bolt and move the link to the side. The truck must be supported allowing the rear axle to 'droop' in order to provide clearance for removal of the driver-side tailpipe/muffler assembly.
Refer to Figure 3.
6. Remove both nuts securing the muffler hanger bracket to the crossmember. Remove the front hanger and driver-side tailpipe hanger from the factory muffler assembly. Remove the assembly from the truck.
Refer to Figure 4.

Installation of MBRP Inc. Performance Exhaust:

1. Install the **2-Bolt Flange** onto the **Front Pipe**. Be sure the chamfer on the ID of the flange is facing the flare on the pipe.
2. Loosely install the **Front Pipe** using the OEM nuts previously removed. The **Front Pipe** may require cutting based on the cab/box configuration.
Refer to Figure 5.

CAB TYPE	BOX LENGTH	WHEELBASE	FRONT PIPE LENGTH
QUAD CAB	6'4"	140.5"	26.75"
CREW CAB	5'7"	144.6"	30.75"
CREW CAB	6'4"	153.5"	39.75" [NO CUT REQ'D]

3. Install a **3" Clamp** on the outlet of the **Front Pipe** before installing the **Extension Pipe**. Insert the hanger into the rubber isolator on the truck.
Refer to Figure 6.



Figure 6

4. Install a **3" Clamp** on the outlet of the **Extension Pipe** before installing the **Muffler**. Be sure the outlets are adjusted to be horizontal.
Refer to Figure 7.



Figure 7

5. Reinstall the Muffler hanger bracket onto the truck. Remove the rubber isolators to assist with the next step.

6. Install a **2.5" Clamp** onto each of the Muffler outlets. Install the **Driver-Side Over-Axle Pipe** and **Passenger-Side Over-Axle Pipe** into the **Muffler**. Once installed, reinstall the rubber isolators onto the pipe hangers, then onto the muffler hanger bracket.
Refer to Figure 8.



Figure 8

7. Install a **2.5" Clamp** onto the outlet of the **Driver-Side Over-Axle Pipe**. Install the **Driver-Side Tail Pipe** and install the hanger through the rubber isolator.
Refer to Figure 9.

8. Reinstall the upper sway bar link bolt.

9. Install a **2.5" Clamp** onto the outlet of the **Passenger-Side Over-Axle Pipe**. Install the **Passenger-Side Tail Pipe** and install the hanger through the rubber isolator.
Refer to Figure 10.



Figure 9

10. Install the **Tips** and adjust to your preference. Adjust all pipes as required and tighten all the clamps.

11. Check along the whole length of the exhaust system to ensure that there is adequate clearance around the frame, body, fuel and brake lines and any wiring. If any interference is detected, relocate or adjust.



Figure 10

Congratulations! You are ready to begin experiencing the improved power, sound and driving experience of your *MBRP Inc.* performance exhaust system. We know you will enjoy your purchase.