

FREE SHIPPING ON ORDERS OVER \$98*

INSTALL INSTRUCTIONS FOR 75-5124

PART#: 75-5124 / 75-5124D

Vehicle Application

YEAR: 2019-2021

MAKE: Ram

MODEL: 1500, 2500, 3500

ENGINE: 5.7L

Tools Required

- Ratchet with Ratchet Extension Bar
- 8mm, 10mm, 11mm, 13mm Socket
- Panel Popper
- Crescent Wrench
- Phillips/Flat Blade Screwdriver
- Scissors
- Panel Popper

Note: Approximate Install Time: 1 Hr 00 Mins.

S&B Filter Maintenance

KF-1069 Cotton Cleanable : If the enclosed filter is RED, it came pre-oiled from the factory. Click here for exact oil amount required for cleaning.

KF-1069D Dry Extendable : If the enclosed filters is WHITE, it is a disposable filter and should be discarded once it reaches capacity. This filter does not require oil.

Note: This kit will not fit the 2019 Ram 1500 Classic. This intake kit may not fit with the following Aftermarket Parts installed:

- Body Lift or Lowering Kit
- Custom Hood
- Throttle Body Spacer / Upgrade

CARB Status - Pending

CARB EO # Pending

*Not Legal for use in CA and other states adopting CA emissions Standards.

Before You Start

- Please read the entire product guide before proceeding.
- Ensure all parts are present.
- If you are missing any of the components, call our customer support at (909) 947-0015.
- Do not work on your vehicle while the engine is hot.
- Make sure the engine is turned off and the vehicle is in Park or the Parking Brake is set.

Related Products

- Cotton Cleanable Filter (KF-1069)
- Dry Extendable Filter (KF-1069D)
- Cleaning & Oiling Kit (88-0008)

 **Support**

PARTS LIST

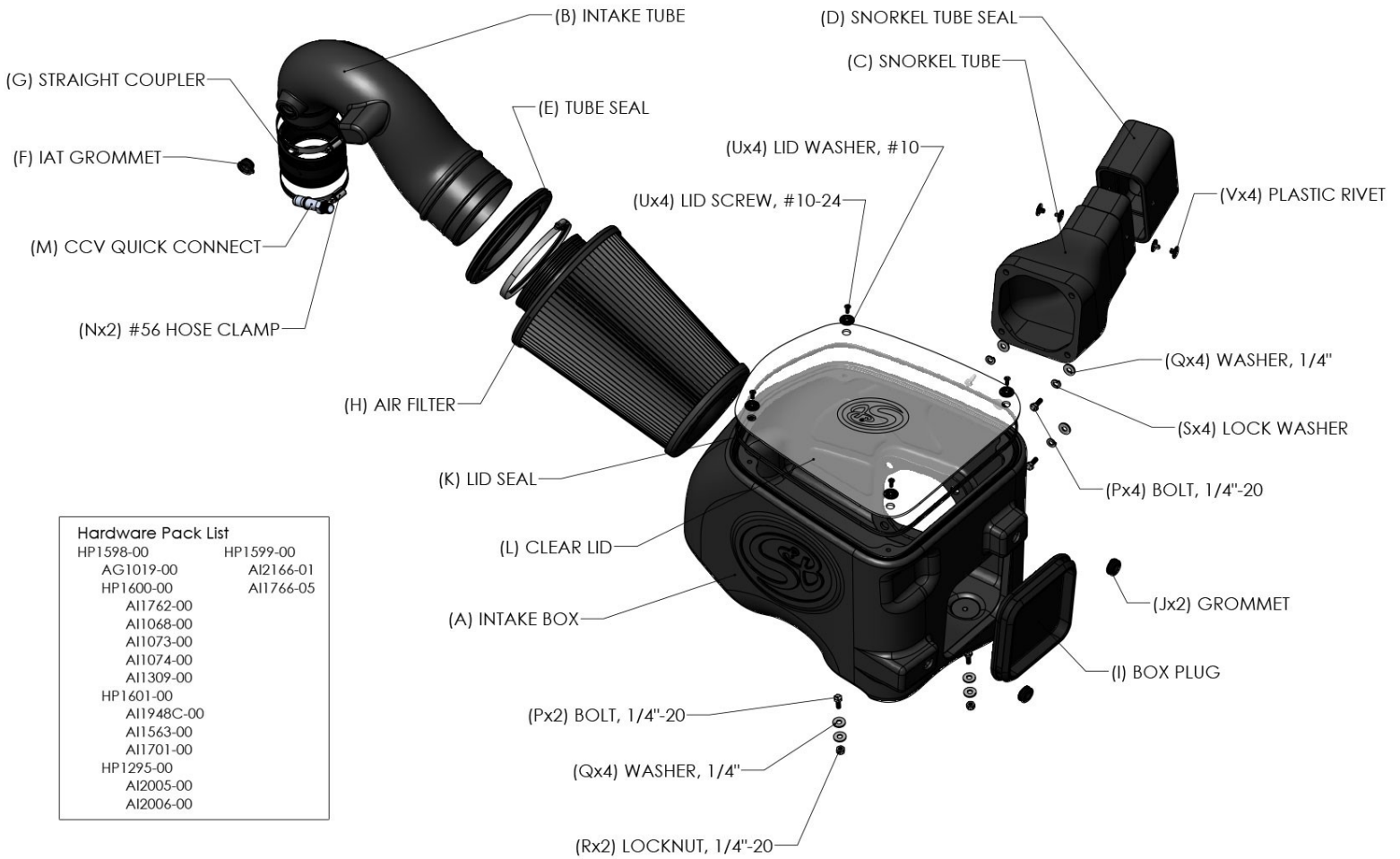

ITEM	QTY	DESCRIPTION	P/N
A	1	INTAKE BOX	AL1346B-00
B	1	INTAKE TUBE	AL1346-00
C	1	SNORKEL TUBE	AL1346S-00
D	1	SNORKEL TUBE SEAL	AI2165C-00
E	1	TUBE SEAL	AI1717C-01
F	1	IAT GROMMET	AI1948C-00
G	1	STRAIGHT COUPLER	AI1678C-00
H	1	AIR FILTER	KF-1069
I	1	AIR BOX PLUG	AI1718C-00
J	2	GROMMET	AI1563-00
K	1	LID SEAL, 48"	AI1766-05

ITEM	QTY	DESCRIPTION	P/N
L	1	CLEAR LID	AI2166-00
M	1	CCV QUICK CONNECT	AI1701-00
N	2	HOSE CLAMP, #56	AG1019-00
O	1	HOSE CLAMP, #88	AG1011-00
P	6	BOLT, HEX HEAD, 1/4"-20	AI1068-00
Q	8	WASHER, FLAT, 1/4"-20	AI1073-00
R	2	LOCKNUT, NYLON, 1/4"-20	AI1074-00
S	4	WASHER, LOCK, 5/16"	AI1309-00
T	4	LID WASHER, #10	AI2006-00
U	4	LID SCREW, #10-24	AI2005-00
V	4	PLASTIC RIVET	AI1762-00

INSTALLATION STEPS

STEP 1

With the ignition switched off and the parking brake set. Disconnect the negative battery cable on the driver side.

IMPORTANT: Failure to disconnect the battery for a minimum of 2 hours may cause the Check Engine Light to illuminate upon completion of the installation or subsequent operation. DO NOT SKIP THIS STEP!

Tools Required: Ratchet, 10mm Socket.

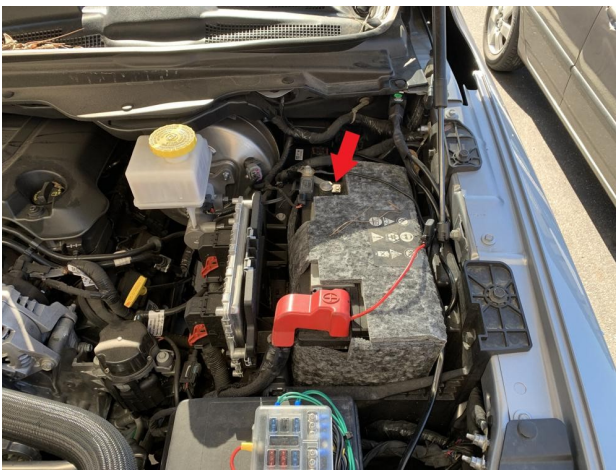

STEP 2

Press down on the plastic clip to disengage the lock on the fitting then pull away to disconnect the CCV hose.



STEP 3

Press down on the tab then disconnect the IAT sensor harness from the IAT sensor.



STEP 4

Loosen the hose clamp at the throttle body then pull the intake tube away from the throttle body. Tools Required: Ratchet, 8mm Socket

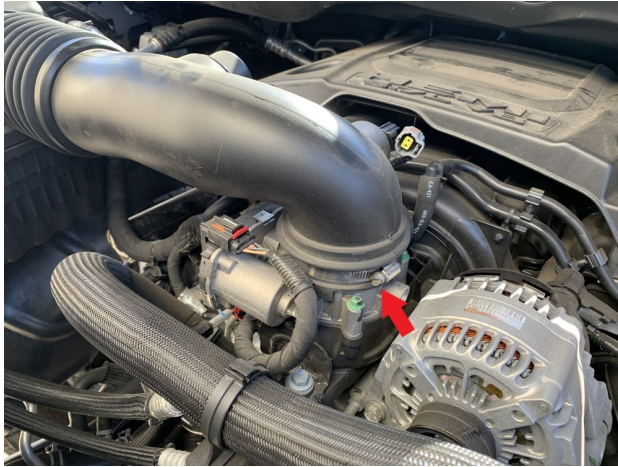
**STEP 5**

Loosen the hose clamp at the intake box then completely remove the intake tube from the vehicle. Tools Required: Ratchet, 8mm Socket

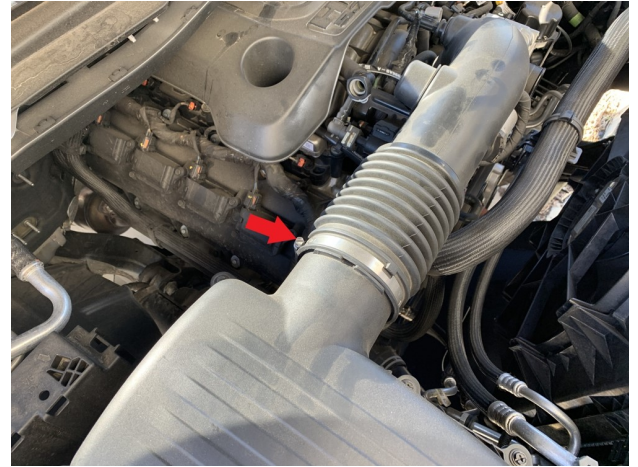
**STEP 6**

Remove the two 8mm screws underneath the front passenger side wheel liner. Tools Required: Ratchet, 8mm Socket

**STEP 7**

Lift the intake box to unseat the grommets from the intake box tray then remove from the intake box from the vehicle.



STEP 8

Unclip the five wire harness clips attached to the intake box tray and one attached to the ac line. Tools Required: Panel Popper

**STEP 9**

Remove the four bolts securing the intake box tray. Set two bolts aside, they will be used in Step 21. Tools Required: Ratchet, Ratchet Extension Bar, 13mm Socket

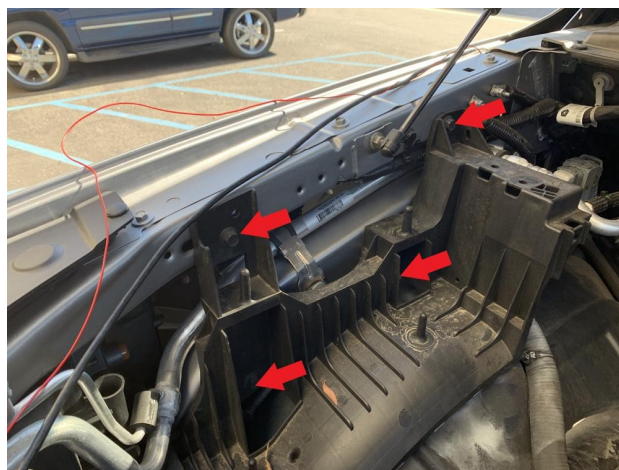
**STEP 10**

Remove the intake box tray and intake inlet from the vehicle.

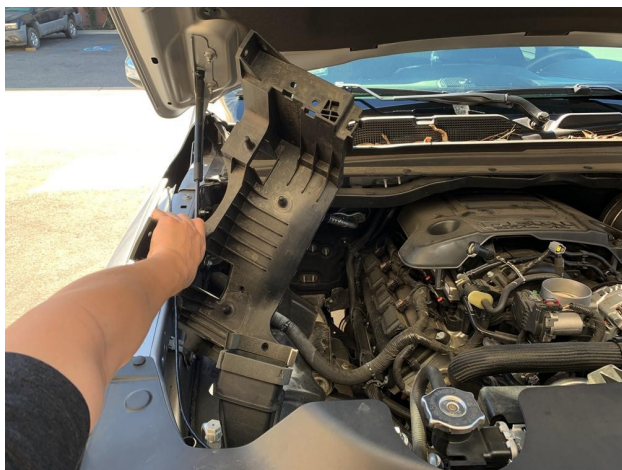
**STEP 11**

Install the Tube Seal (E) onto the Intake Box (A).



STEP 12

Install the two Grommets (J) onto the Intake Box (A).

**STEP 13**

Determine if you want to install the Box Plug (I) onto the Intake Box (A) or leave the secondary inlet open. If the Box Plug is desired, simply press the Box Plug onto the box opening until the box plug snaps into place. **When to use the Box Plug?** Stock intake boxes are a significant contributor to poor air flow which is why S&B designs custom air boxes with secondary and/or enlarged openings. With that said, S&B recognizes the benefits of cooler air, so we have included a plug to seal off the opening if desired. For optimal performance, we recommend that the intake be used without the box plug, except in conditions of extreme heatwave.

**STEP 14**

Install the Quick Connect Fitting (M) into the Intake Tube (B) until hand tight, then use a crescent wrench and tighten it another one to two complete turns.

IMPORTANT: Do not over tighten, as the Quick Connect Fittings can break or the threaded inserts may strip!

**STEP 15**

Install the IAT Sensor Grommet (F) onto the Intake Tube (B).



STEP 16

Use a Flat Blade Screwdriver to carefully prop up the locking tab to assist in removing the IAT sensor. Turn the sensor counterclockwise to unlock then pull out. Tools

Required: Flat Blade Screwdriver

**STEP 16B**

Install the IAT sensor into the Intake Tube (B).

**STEP 17**

Install the Coupler (G) with the two #56 Hose Clamps (N) onto the throttle body then tighten the hose clamp on the throttle body. Do not overtighten. Leave the other hose clamp for the Intake Tube (B) loose. Tools Required:

Ratchet, 8mm Socket

**STEP 18**

Install the Snorkel Tube Seal (D) onto the Snorkel Tube (C) then press together the Plastic Rivets (V) to secure. You should be able to hear the plastic rivets locking into place.

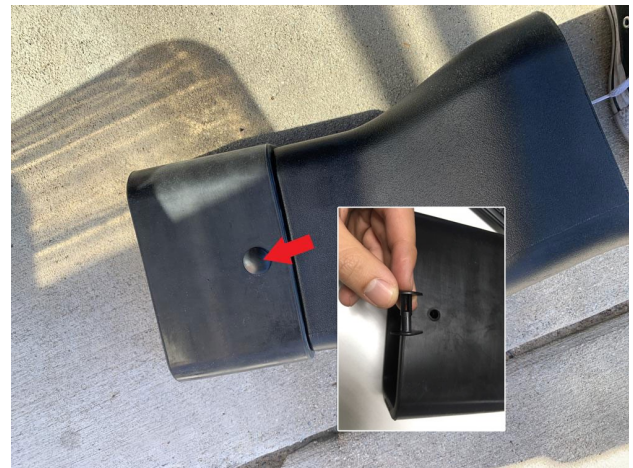

STEP 19

Install the Snorkel Tube and Snorkel Tube Seal (C & D) assembly onto the stock elbow inlet.

**STEP 20**

Install the Intake Box (A) into the vehicle and slightly tip the Snorkel Tube (C) assembly to align the mounting holes with the intake box.

**STEP 20B**

Install the Bolts (P), Lock Washer (S) and Washer (Q). Do not overtighten. Tools Required: Ratchet, 11mm Socket

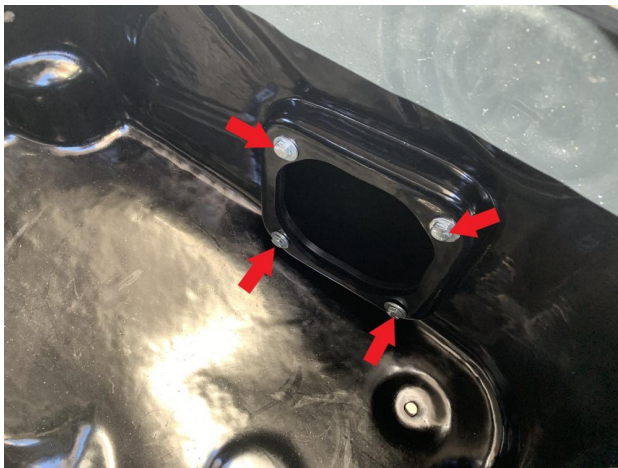
**STEP 21**

Align the two mounting holes on the Intake Box (A) with the fender and use the bolts removed in Step 9 to fully secure the intake box. Do not fully tighten, leave the bolts loose so you can still move the box to align the holes on the wheel liner and the intake box. Tools Required: Ratchet, Ratchet Extension Bar, 13mm Socket



STEP 22

Align the mounting holes on the wheel liner with the Intake Box (A) then tighten with the Bolt (P), Washer (Q) and Lock Nut (R). Fully tighten the two bolts from Step 21. Do not overtighten. Tools Required: (2) Ratchet, (2) 11mm, 13mm Socket

**STEP 23**

Install the Intake Tube (B) into the Intake Box (A) and Coupler (G). Tighten the #56 Hose Clamp (N). Do not overtighten. Tools Required: Ratchet, 8mm Socket

**STEP 24**

Install the Air Filter (H) onto the Intake Tube (B) and tighten the #88 Hose Clamp (O). Do not overtighten. Tools Required: Ratchet, 8mm Socket

**STEP 25**

Install the Lid Seal (K) onto the grooves on top of the Intake Box (A).



STEP 26

Make sure all hose clamps and bolts are fully secured then remove the protective covering from the Clear Lid (L).

**STEP 27**

Place the Clear Lid (L) on top of the Intake Box (A) then secure with the Lid Screws (U) and Washers (T). Do not overtighten. Tools Required: Phillips Screwdriver

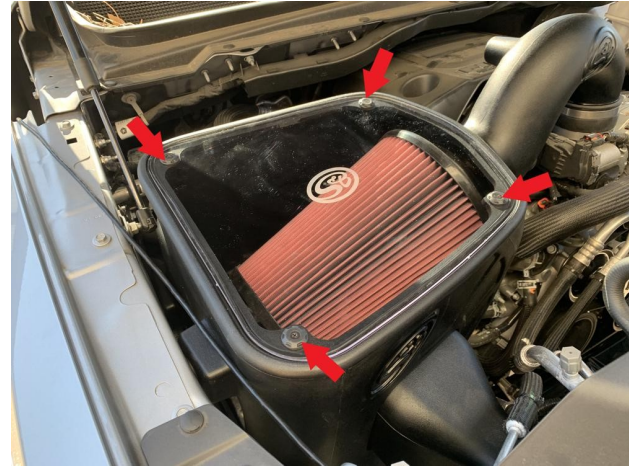
**STEP 28**

Reinstall the IAT sensor harness into the IAT sensor.

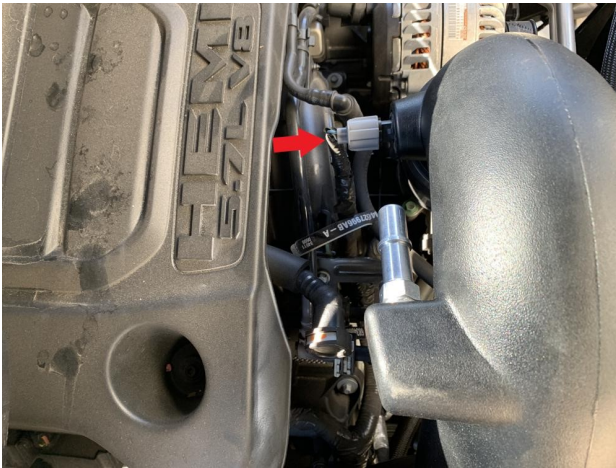
**STEP 29**

Press down on the plastic clip to reinstall the CCV hose into the Quick Connect Fitting (M).



STEP 30

Reconnect the negative terminal on battery. Inspect your installation, make sure the kit is properly positioned and all fasteners are secured. S&B Filter recommends keeping all stock parts in case you would ever need to reinstall the stock intake. Affix the ID label near the intake kit. The installation is now complete. Tools Required: Ratchet, 10mm Socket



Performance Testing

- Engage parking brake and start your engine. Listen for abnormal noises. If an air leak is detected, re-inspect hoses and connections as they may need to be repositioned and tightened.
- S&B FILTERS recommends that you keep your OE intake system in the event it is required in the future.
- In order to maintain your warranty, all connections and components must be checked periodically for alignment and for proper tension on all connections. Failure to do so may void your warranty.
- Use only S&B FILTERS cleaning and oil products to service your filter. Using any other brand oil and or cleaners on your S&B air filter may void your warranty.

Warning!

If your vehicle has a Vehicle Emission Control Information decal affixed to the factory airbox, a new replacement label must be obtained and installed in a readily visible position in the engine compartment in order to remain CARB compliant. Failure to do so will prevent the vehicle from passing a smog check. Replacement labels can be ordered from your local dealership. Regulations state that the VEI label shall not be affixed to any equipment which is easily detached from the vehicle. Label placement, under the hood on a painted surface is recommended.