



INSTALLATION INSTRUCTIONS

DPF-Back Exhaust

MAKE: Jeep
 MODEL: Gladiator EcoDiesel
 YEAR: 2021-2022
 ENGINE: V6-3.0L (td)

49-38095-P
 49-38095-B

NOTE: Only fits EcoDiesel Model. Fits up to a 35" Tire.

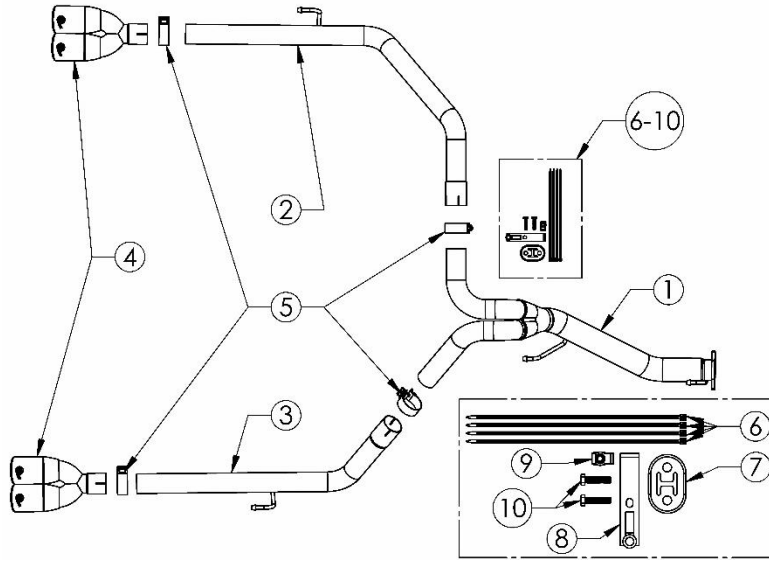

Item	Description	Part Number	Quantity
1	Over-Axle Assembly	05-245276	1
2	Driver Side Tailpipe	05-245277	1
3	Passenger Side Tailpipe	05-245278	1
4	Tip, Exh: 2.5" IN x 3.75" OUT X 12"L (Pol)	49T25374-P12	2
4	Tip, Exh: 2.5" IN x 3.75" OUT X 12"L (Blk)	49T25374-B12	2
5	Clamp, Band: 2-1/2"	05-41061	4
6	Ties, Nylon Cables: 12"	05-60167	4
7	Exhaust Isolation Mount	05-46050	1
8	Bracket Hanger	05-46404	1
9	Nut, Clip-On	05-60104	1
10	Bolt, Hex Flange	03-50404	2

aFe POWER recommends professional installation on this product. Thoroughly inspect the aFe POWER exhaust system to make sure there is no damage from shipping (if damage is noted, immediately contact aFe POWER customer service). Allow time for your vehicle to cool down prior to installation. When working on your vehicle proceed with caution. Wear protective safety equipment; eye goggles and gloves to ensure a safe installation.

Install band clamps to proper torque specifications of 40-45 ft-lb.

Install V-band clamps with anti-seize lubricant and hand tighten only to torque specifications of 10-15 ft-lb.





INSTALLATION INSTRUCTIONS

MAKE: Jeep
MODEL: Gladiator EcoDiesel
YEAR: 2021-2022
ENGINE: V6-3.0L (td)

DPF-Back Exhaust

49-38095-P

49-38095-B

NOTE: Only fits EcoDiesel Model. Fits up to a 35" Tire.

1. **(Read instructions prior to installation.)** It is recommended to not fully tighten the exhaust until it has been fully installed. Leave loose for adjustability.
2. Secure vehicle on jack stands (refer to your manual for specified jack stand positions).
3. For faster installation, spread out the parts of the exhaust alongside your vehicle as shown in the diagram above.
4. Secure the stock exhaust with jack/stands.
5. Remove the spare tire and tire guard. This will allow for clearance to remove the exhaust.
6. Undo the two the bolts at the front of the O.E. exhaust and remove exhaust in one piece. Retain O.E. Bolts and Gasket for Installation of aFe Exhaust System.
7. Install the aFe Power Bracket Hanger on the driver side as shown in the image above using the provided hardware. Once aFe Power Bracket Hanger is installed, slide the provided Exhaust Isolation Mount onto the hanger.
8. Install the aFe Power Over-Axle Assembly at the front of the vehicle using the O.E. Gasket and the two O.E. bolts to secure it. Install Hanger into O.E. Exhaust Isolation Mount.
9. Slide aFe Power Driver Side Tailpipe into the aFe Power Over-Axle Assembly and secure with provided 2-1/2" Band Clamp. Install Hanger into aFe Power Exhaust Isolation Mount.
10. Slide aFe Power Passenger Side Tailpipe into the aFe Power Over-Axle Assembly and secure with provided 2-1/2" Band Clamp. Install Hanger into O.E. Exhaust Isolation Mount.
11. Install both aFe POWER exhaust tips using the provided 2.5" clamps.
12. Use the provided (x4) zip ties to tie up the rear differential breather tube and any lines that might be close to the exhaust.
13. Re-Install spare tire guard and the spare tire.
14. Ensure that all the components of the aFe POWER exhaust system are aligned and are at a safe clearance from all wires, hoses, brake lines, body parts, and tires.
15. Start from the front of the aFe exhaust system and evenly tighten all clamps and fasteners.
16. Start the vehicle and check for any leaks. If any leaks are found, determine cause and repair as necessary.
17. Remove vehicle from jacks stands.
18. It is recommended to re-tighten all clamps and hardware after 50-100 miles.